

User Manual Of JWA101 Beacon

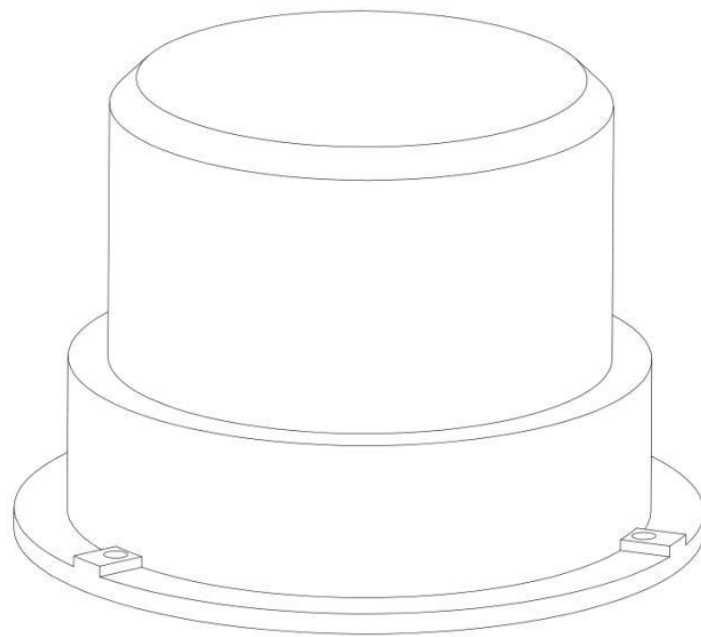

Table of Contents

| | |
|---|---|
| 1. Overview..... | 3 |
| 2. Main technical parameters..... | 3 |
| 3. How to Use..... | 3 |
| 4. Product Dimensions and Installation..... | 4 |
| 5. Transportation and storage requirements..... | 4 |
| 6. Unpacking and inspection..... | 4 |
| 7. Attention..... | 5 |
| 8. Safety warnings..... | 5 |
| 9. After sales..... | 5 |

1. Overview

JWA010 waterproof warning light is used in dark and noisy places, and it will emit light source and voice prompts after installation.

1.1 Product Features

1.1.1 Except for the internal circuit board, all the materials of the whole machine are made by injection molding of PC material;

1.2 Scope of application

1.2.1 Ambient temperature: $-40^{\circ}\text{F}\sim+140^{\circ}\text{F}$

1.2.2 Relative humidity: $\leq 95\%$ (at room temperature)

1.2.3 Atmospheric pressure: $80\sim 110\text{KPa}$

2. Main technical parameters

2.1 Input voltage: DC12-24V

2.2 Standby, working current: $\leq 1\text{mA}$

2.3 Anti-corrosion grade: WF1

2.4 Protection level: IP66

2.5 Specification: $\phi 5.1'' * 3.7''$

2.6 Installation method: fix with three cross ST3.5 self-tapping screws

2.7 Net weight: 0.5 LBS

3. How to Use

The positive and negative poles of the two wires are connected, the warning light flashes, and the reminder function.

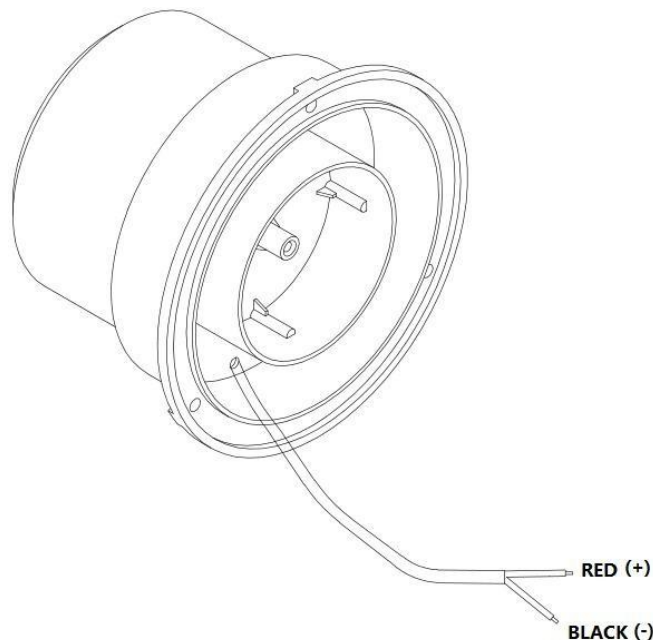

4. Product Dimensions

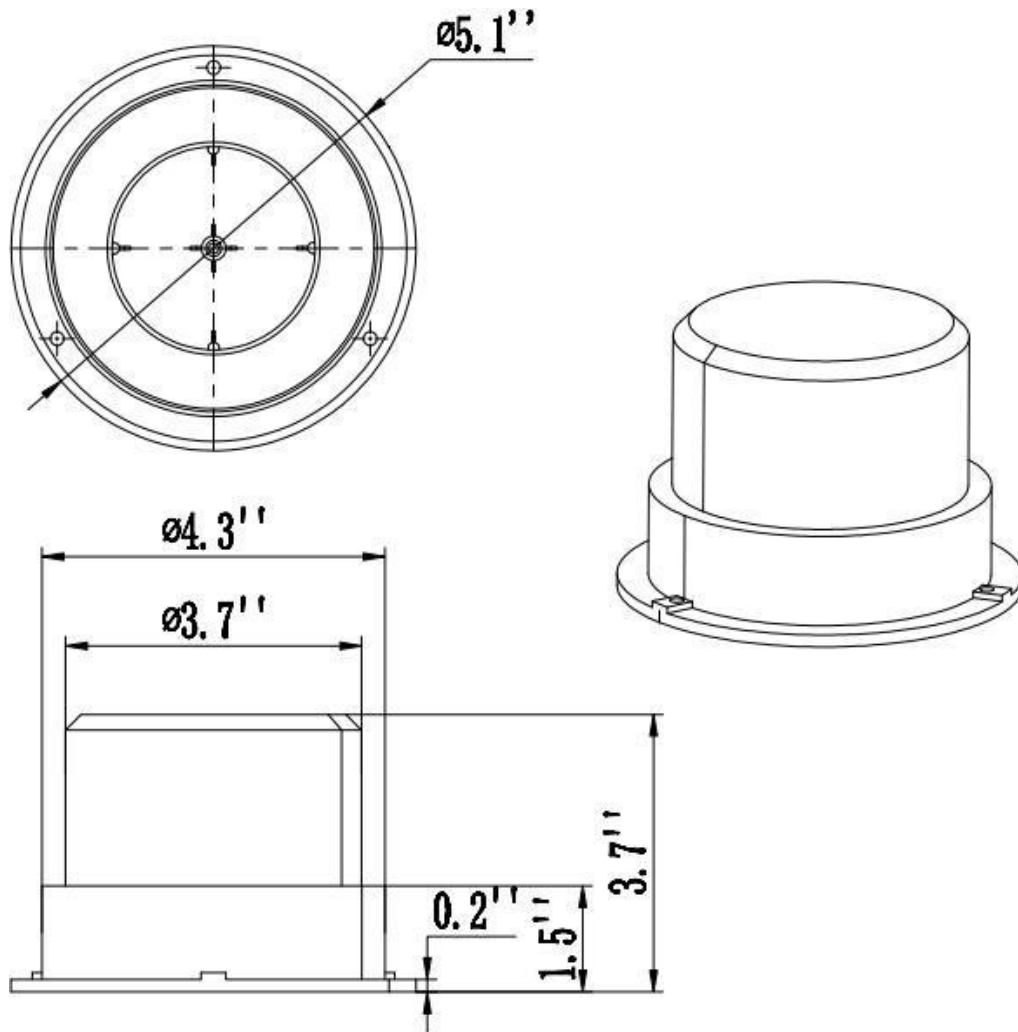

5. Transportation and storage requirements

5.1 During transportation, the product is not allowed to be subjected to severe mechanical shock or direct sunlight and rain, to prevent falling, collision, and heavy pressure.

5.2 The product should be stored in a dry, clean, well-ventilated environment at ambient temperature (0-40 ° C), in a non-corrosive medium warehouse, away from fire and heat sources.

6. Unpacking and inspection

6.1 Check that the instruction manual, product certificate, product warranty card and accessories in the box are complete.

6.2 The appearance of the product shall be checked and the marking shall be complete.

7. Attention

7.1 Please read this manual before use to understand the product performance and use methods, so as to avoid accidents and damage to the product due to mis-operation.

7.2 The product should be checked carefully before use to ensure that it is installed and used without damage by external forces.

7.3 The product should be stored in a cool, clean and dry environment.

8. Safety warnings

8.1 It is strictly forbidden to disassemble the product and replace parts without permission.

8.2 It is strictly forbidden to install or repair under power, otherwise it will cause danger.

8.3 Cruel hitting the product is strictly prohibited.

8.4 When the product fails, it is strictly forbidden to repair in the danger area.

8.5 Never open the cover with power on.

9. After sales

The Warranty of Joiwo products is 1 years. Within 1 years since the products are shipped, if there is any quality issue or technical requirements, we will take care of all the trouble shooting and send the spare parts or complete product as required for replacements at our charge.

If you have any questions about using this product, please contact Ningbo Joiwo Explosionproof directly (Detail contact information pls see cover).